

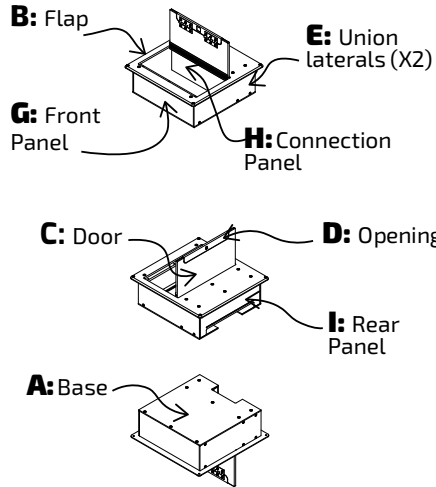

CUBOID INS

Installation Manual

Description of the parts



1. Make a cut on the floor following the recommended dimensions depending on the model.



! For the Cuboid Ins box to align with the floor, make a 6mm recess around the hole made to the outside dimension of the Flap (B) depending on the model.

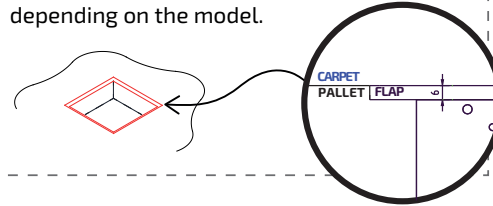

2. Pull all the cables through the opening made to work comfortably.

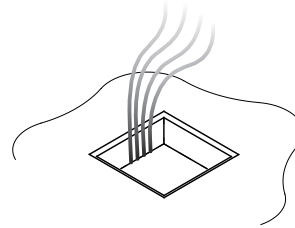

3. Unscrew the Base (A).

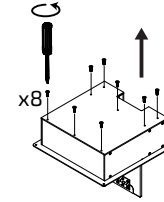

4. Unscrew the Rear Panel (I).

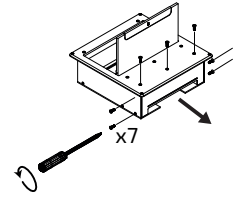

5. If the previous steps are not sufficient to connect the cables, unscrew the connectors from the connection panel (H), pass the cables through their holes and connect. Screw the connectors back into the Connection Panel (H).

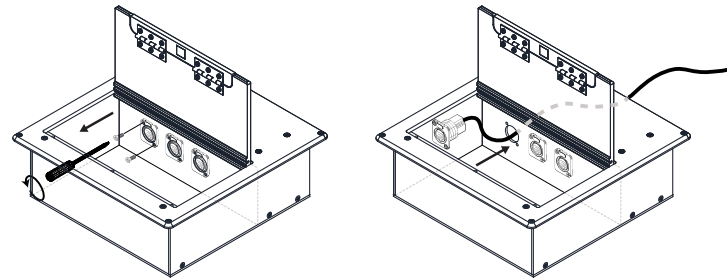

6. Screw the Rear Panel (I).

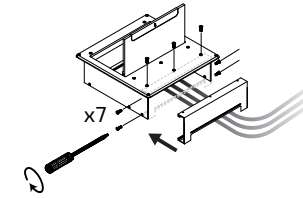

7. Tie the cables.

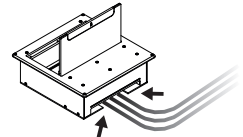

Never unscrew screws other than those indicated in this manual.

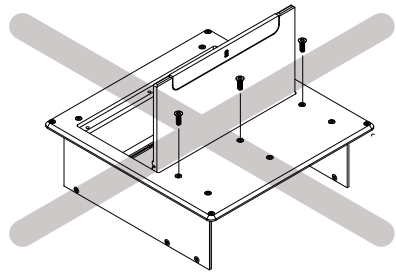

8. Screw the Base (A)

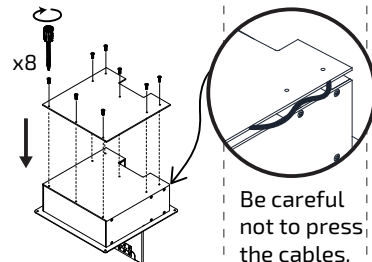

9. Screw the Cuboid Ins box to the floor.

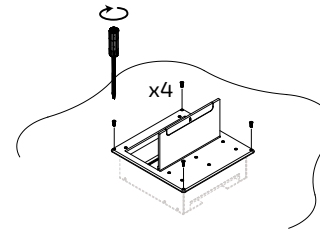

10. If it is needed to stick carpet, leave a relief space in the Door (C) at the hinge area = Carpet thickness + 1mm

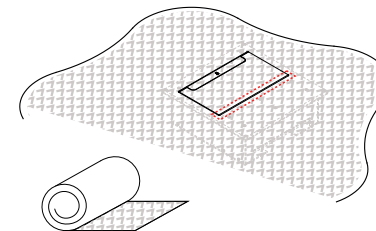

11. You can open the Door (C) of your Cuboid Ins box with a piece of iron.

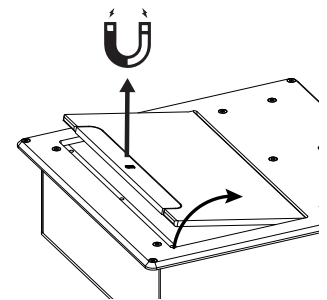



CUBOID INS

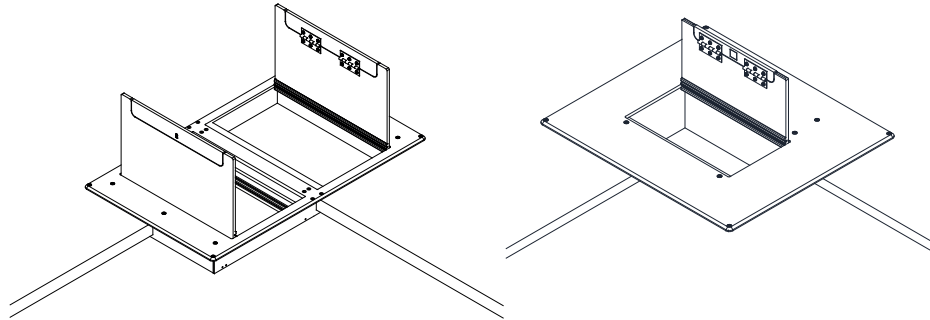

If your model is customized,
you will find the dimensions
in the graphic view sent

CUB INS 1UMM

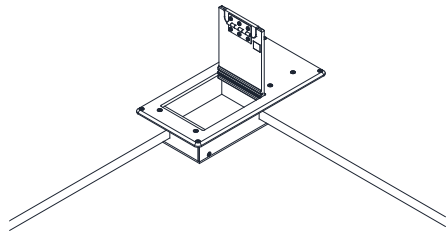

DIMENSIONS

(width x height x depth)

144 x 293 x 47.5mm



(width x height)

115 x 255mm

CUB INS 2UMM

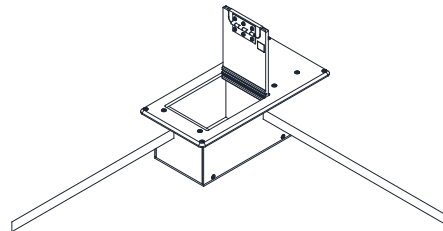

DIMENSIONS

(width x height x depth)

144 x 293 x 92mm



(width x height)

112 x 255mm

CUB INS 1UM

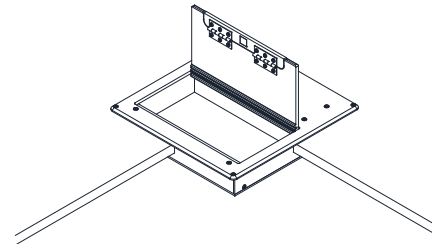

DIMENSIONS

(width x height x depth)

287 x 293 x 47.5mm



(width x height)

255 x 255mm

CUB INS 2UM

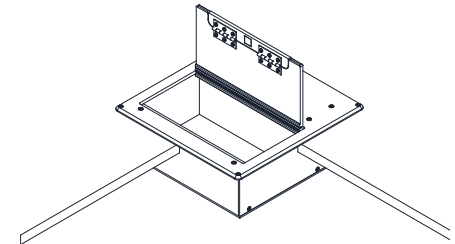

DIMENSIONS

(width x height x depth)

287 x 293 x 92mm



(width x height)

255 x 255mm